



**TODDLER
DESIGN SHOWCASE
CATALOGUE**



where kids want to play



THOUSANDS
of playsystems installed
around the world



WORLD-CLASS PRODUCTS,
PERSONALIZED SUPPORT

SPI has been developing, designing, manufacturing and servicing the play market since 1995. We are honored to have our playsystems installed around the globe.

Our approach to business is simple yet effective; we call it our **5 STAR STRATEGY**

- * We offer the highest **Quality** products that require the least amount of maintenance and are the most durable.
- * Our designers are continually trained and kept up to date on international **Safety** standards.
- * SPI designs are created to maximize the **Fun** potential of any space available. We offer the largest number of activity options in the industry.
- * **Innovation** is a never-ending quest for SPI. We are constantly developing new playsystems, new activities and new designs to keep up with the requirements of our clients and the expectations of children around the world.
- * We strongly believe in building **Partnerships** with our clients. Whether it is in the early design stages of a project, installation or after-sales service; we are always there.

This catalogue has been prepared to provide an overview of our diversification in design capacity. However, our objective is to listen to our clients and offer **CUSTOM** designs created for each project's requirements!



KS1840A TODDLER UNIT

PLAY EVENTS

1. (2) Activity Panels: Ball Turn & Gyro
2. (2) KidsCube™ Climbs: 2 level & 3 level
3. (1) Twist 'N Turn
4. (1) Crawl Tube
5. (1) 3' Curved Tot Slide

CAPACITY

16

HEIGHT

9' 5" (2.9 m)

Graphics Packages Available.

Does not include Flooring, Installation or Shipping.

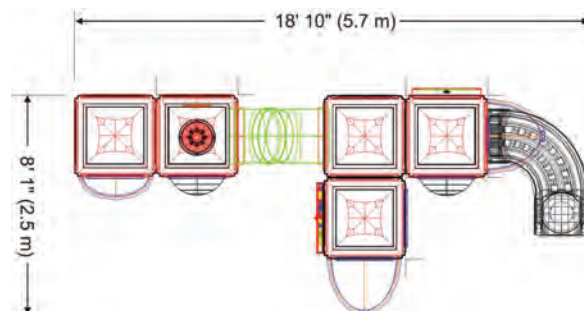

PLAY EVENTS

1. (2) Activity Panels: Ball Turn & Gyro
2. (1) Mega Climb: 2 level
3. (4) Steering Wheels
4. (1) 2' Tot Slide

CAPACITY

10

HEIGHT

8' (2.4 m)

Graphics Packages Available.

Does not include Flooring, Installation or Shipping.

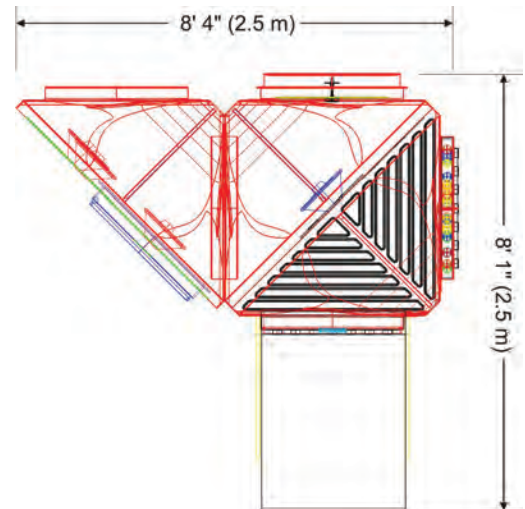

KS1840B TODDLER UNIT





KS1840C TODDLER UNIT

PLAY EVENTS

1. (2) Activity Panels: Ball Turn & Gyro
2. (1) Mega Climb: 2 level
3. (1) 2' Tot Slide

CAPACITY

6

HEIGHT

6' (1.8 m)

Graphics Packages Available.

Does not include Flooring, Installation
or Shipping.

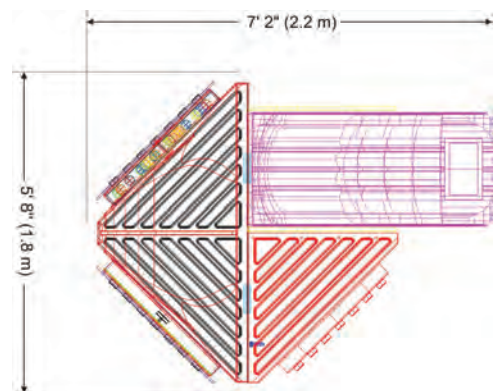

PLAY EVENTS

1. (2) Activity Panels: Ball Turn & Gyro
2. (1) KidsCube™ Climbs: 4 level
3. (1) Sky Spinner
4. (1) Pull Up Rings
5. (1) Jump Cube

CAPACITY

11

HEIGHT

12' 6" (3.8 m)

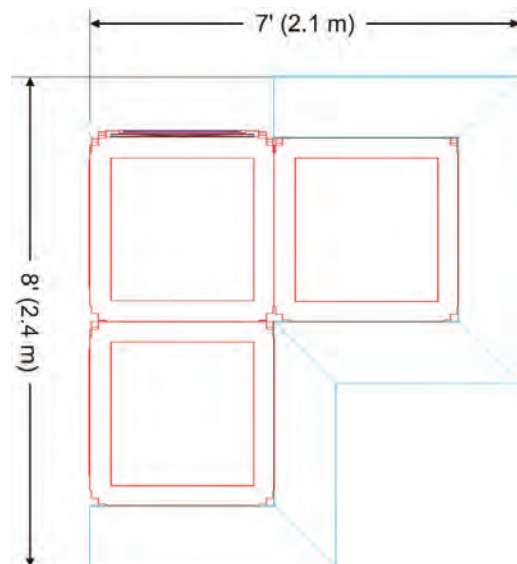

Graphics Packages Available.

Does not include Flooring,
Installation or Shipping.

KS1840D TODDLER UNIT





KS1840E TODDLER UNIT

PLAY EVENTS

1. (2) Activity Panels: Ball Turn & Gyro
2. (1) KidsCube™ Climbs: 3 level
3. (1) Toddler Bedrock Climber
4. (1) 3' Curved Tot Slide

CAPACITY

9

HEIGHT

8' (2.4 m)

Graphics Packages Available.

Does not include Flooring, Installation
or Shipping.

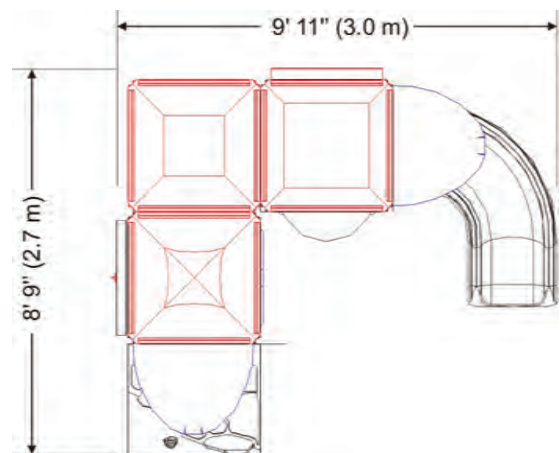

PLAY EVENTS

1. (3) Activity Panels: Gyro, Clock & Tic Tac Toe
2. (1) Deck Climb: 3 level Square Deck
3. (1) Twist 'N Turn
4. (1) Sky Spinner
5. (2) Rock Wall Traverse

CAPACITY

11

HEIGHT

7' 6" (2.4 m)

Graphics Packages Available.

Does not include Flooring, Installation or Shipping.

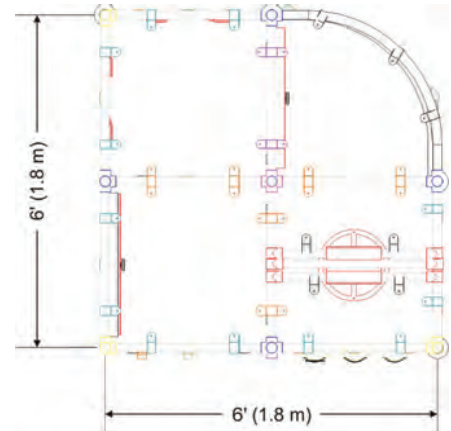

KS1840F TODDLER UNIT





KS1840G TODDLER UNIT

PLAY EVENTS

1. (3) Activity Panels: Ball Turn, Gyro, Tic Tac Toe
2. (1) Deck Climber: 3 level Square Deck
3. (1) Sky Spinner
4. (1) Rock Wall Traverse (2 Panels)
5. (1) Twist 'n Turn Seat with Steering Wheel

CAPACITY

14

HEIGHT

8' (2.4 m)

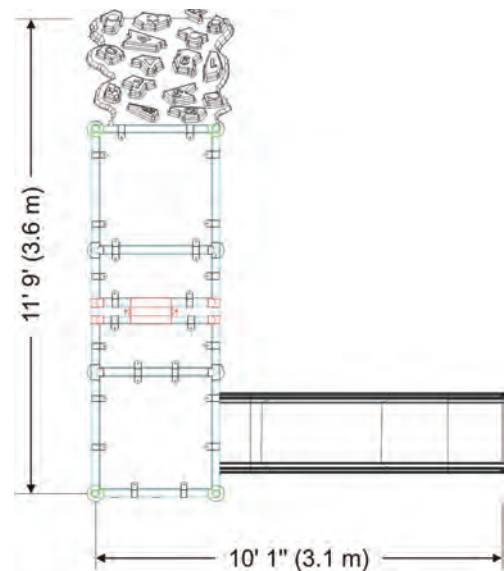

Graphics Packages Available.

Does not include Flooring, Installation or Shipping.

TODDLER PLAY EVENTS



Activity Panels
Alarm Clock



Activity Panels
Alarm Clock

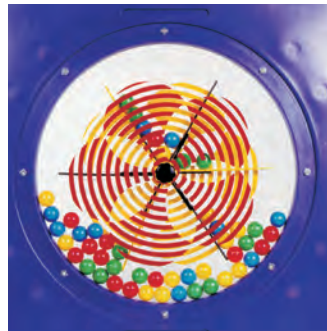

Activity Panels
Ball Turn



Activity Panels
C-Force



Activity Panels
Gyro Spinner

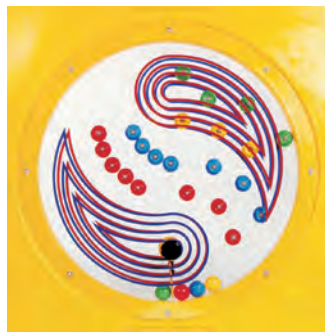

Activity Panels
Pinball



Activity Panels
Tic-Tac-Toe

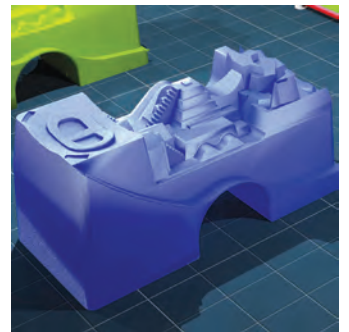

Adventure Table



Riding Animals
Elephant



Riding Animals
Frog



Riding Animals
Whale



Sneaker Keepers
Horizontal



Twist 'N' Turn Seat
with Steering Wheel



2' Tot Slide



3' Curved Tot Slide

PLASTIC COLORS

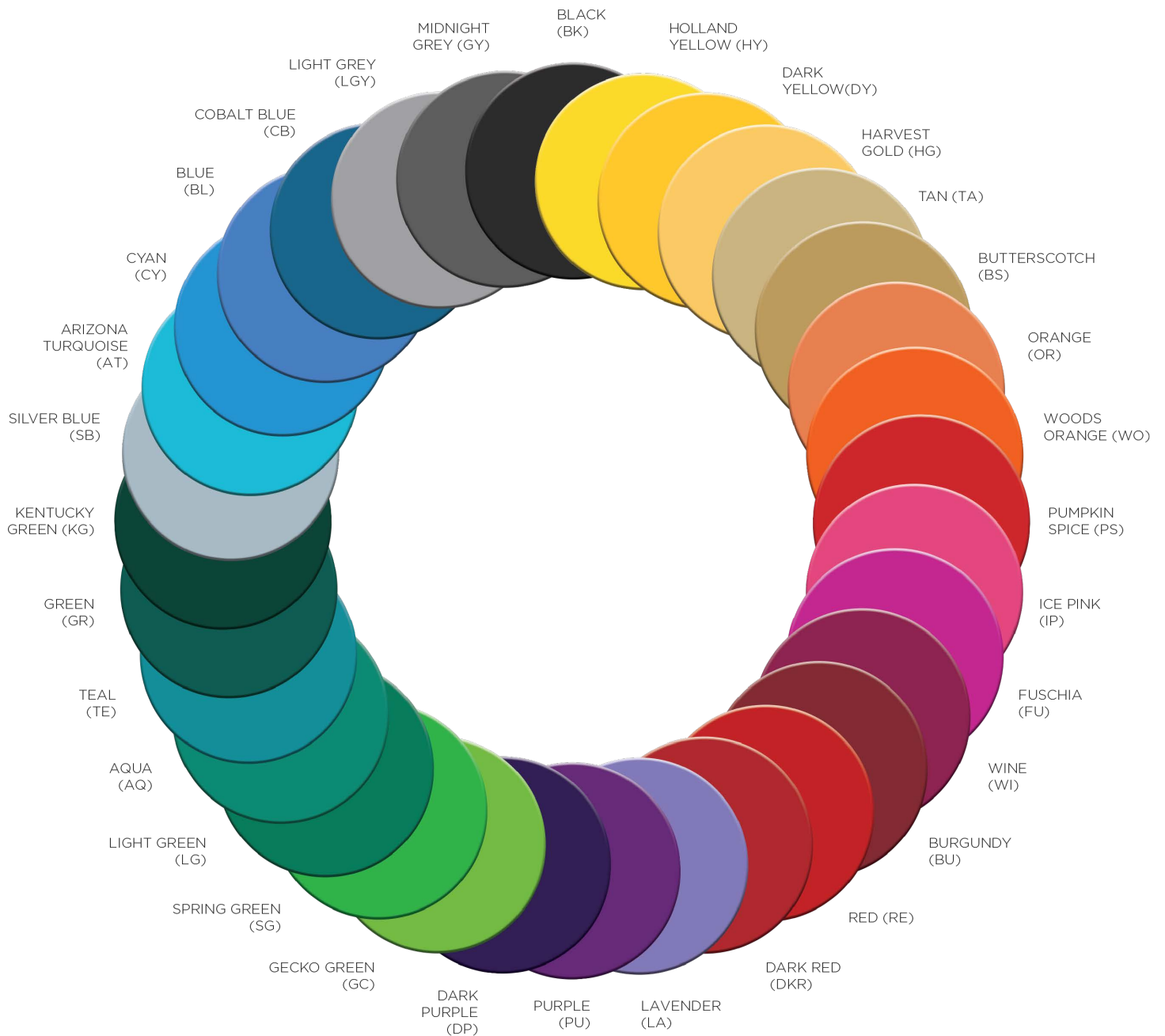

Colours may vary from shown

**** Note:** Pumpkin Spice and Spring Green not suitable for single wall parts.

WARRANTY POLICY

PLAYSYSTEM

The following warranty policy is applicable for installed playgrounds supplied by SPI, where SPI is known as the Supplier. It is the goal of SPI to provide our customers the finest playsystem/play units available.

Supplier warrants to Purchaser the Approved Equipment shall be fabricated in a workable manner, and the Approved Equipment shall be free from defects in material and workmanship for a period of 1 (one) year from the date the installation of the playsystem/play unit is complete. During the stated one year period, the Supplier shall service the Equipment and complete any required repairs to defective parts without charge or provide necessary parts to be self-installed where applicable. Freight of the equipment will be the responsibility of the customer.

Parts required which are not defective shall be replaced at additional cost. Supplier shall not be required to make repairs or replace any parts if damage to the playsystem/play unit is caused by vandalism, abuse or by extraordinary wear and tear. Purchaser agrees to properly notify the Supplier of any defects immediately upon detection. Defective items will be either repaired or replaced by Supplier at Supplier's option.

Supplier shall retain the right to close the operations of the playsystem/play unit during any time the repairs are being made.

Note: Warranty does not cover fading or dirt and grime on safety flooring. Some examples of vandalism include scratching of windows or Plexiglas fence, damage by sharp objects to post padding, netting and vinyl products. Proper cleaning chemicals and procedures must be implemented to maintain warranty. If the play equipment is or has been altered without the permission of SPI, the entire warranty is null and void.

POLYETHYLENE COMPONENTS

SPI provides a 10 (ten) year limited warranty for all SPI Polyethylene Components. This warranty covers structural failure for the value of the product, not including freight charges or labour expense.

Note: Warranty does not cover vandalism or cosmetic issues (such as colour fading).

UPDATED: SEPTEMBER 16, 2015

CONTACT

SPI INDUSTRIES INC. - HEAD OFFICE

Box 100, RR 2
Shallow Lake, ON, Canada N0H 2K0
T 519-935-2211 TF 800-269-6533 E
dcad@spiplastics.com
W www.spiplastics.com
NORTH AMERICA & EUROPE

