



example shown 2' Tube



STRF

Description	Part #	3" Bell	Diameter	Length	Weight
24" - Full 7' Tube	24x7FTB	yes	24" (61 cm)	84" (213.4 cm)	75 lbs. (34 kg)
30" - Full 2' Tube	30x2FTB	yes	30" (76.2 cm)	24" (61 cm)	45 lbs. (20.4 kg)
30" - Full 5' Tube	30x5FTB	yes	30" (76.2 cm)	60" (152.4 cm)	90 lbs. (40.8 kg)
30" - Full 6' Tube	30x6FTB	yes	30" (76.2 cm)	72" (182.9 cm)	105 lbs. (47.6 kg)
30" - Full 7' Tube	30x7FTB	yes	30" (76.2 cm)	84" (213.4 cm)	110 lbs. (49.9 kg)

Description	Part #	Diameter	Weight
Straight Flange	STRF	34.5" (87.6 cm)	5.5 lbs. (2.5 kg)

Dimensions and weights are approximate. Prices subject to change without notice.

- Tubes are an integral part of any playground
- Tubes available for 24" and 30" (61cm and 76.2 cm) diameters

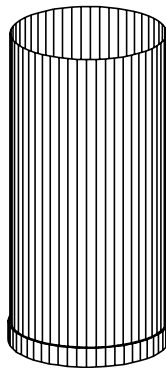
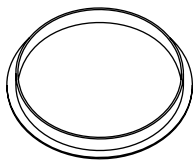
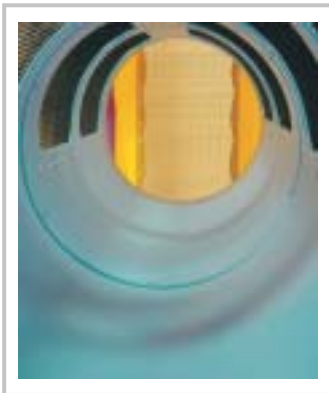

**Specifications**

Complies with:  
CAN/CSA-Z614-03; ASTM

Available Colours:  
All

Polyethylene Density:  
Medium

Packaging:  
Bagged in plastic

Approx. Cubic Size Packaged:  
24x7FTB - 31.8 cub. ft.  
30x2FTB - 16.7 cub. ft.  
30x5FTB - 36.1 cub. ft.  
30x6FTB - 42.3 cub. ft.  
30x7FTB - 49 cub. ft.



800-269-6533  
www.spiplastics.com

