

Tube Exit (Flanged)



Description	Part #	4" Bell	Diameter	Length	Weight
Flanged Tube Exit	EE30	yes	30" (76.2 cm)	39" (99.1 cm)	45 lbs. (20.4 kg)

Dimensions and weights are approximate. Prices subject to change without notice.

- Flanged Tube Exit for the end of your tube slide
- Great sleek appearance



Specifications

Complies with:
CAN/CSA-Z614-03; ASTM

Available Colours:
All

Polyethylene Density:
Medium

Packaging:
Bagged in plastic

Approx. Cubic Size Packaged:
22 cubic feet

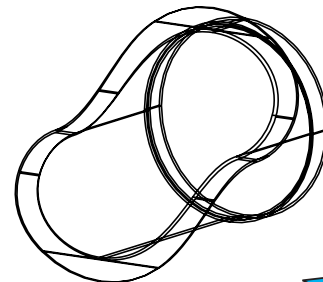

800-269-6533

www.spiplastics.com **SPi COMPONENTS**

Copyright © 2011. SPI Industries Inc.
All rights reserved. Printed in Canada

Tubes & Elbows

