

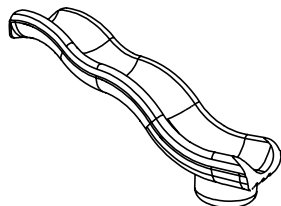

Description	Part #	Deck Height	Width	Bed Width	Length	Weight
4' Double Wall Wave Slide	4DWWS	48" (122 cm)	24" (61 cm)	17" (43.2 cm)	108" (274.3 cm)	75 lbs. (34 kg)
5' Double Wall Wave Slide	5DWWS	60" (152.4 cm)	24" (61 cm)	17" (43.2 cm)	128" (325.1 cm)	104 lbs. (47.2 kg)
6' Double Wall Wave Slide	6DWWS,2002	72" (183 cm)	24 1/2" (62.2 cm)	17 1/2" (44.5 cm)	145" (368.3 cm)	130 lbs. (59 kg)

Dimensions and weights are approximate. Prices subject to change without notice.

- Radius bedway
- Extra large rounded exit and entrance corners provide added strength and safety
- Molded-in foot
- Deck mounting system
- Textured backs
- Slide deck height stamped into foot for ease of recognition



Specifications

Complies with:
CAN/CSA-Z614-03; ASTM

Available Colours:
All

Polyethylene Density:
Medium

Packaging:
Bagged in plastic

Approx. Cubic Size Packaged:
4DWWS - 36 cubic feet
5DWWS - 43 cubic feet
6DWWS,2002 - 48 cubic feet



800-269-6533
www.spiplastics.com

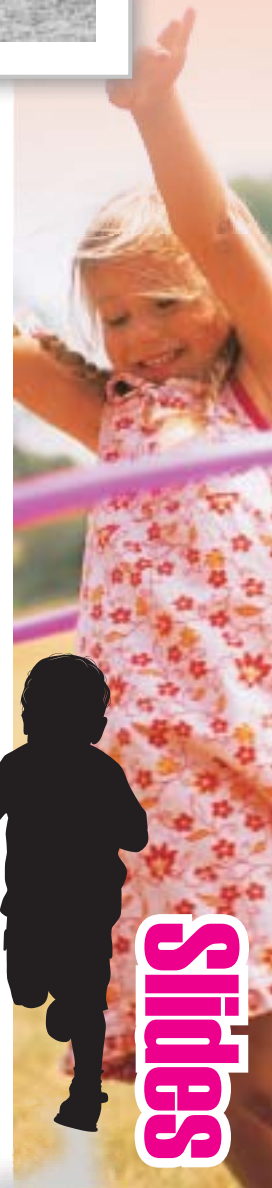

Slides