

* Approximate water flow rate of the Float and Valve System with a standard 40-60 psi is 5 - 7 gallons per minute.

Water Pressure: Please note the valve is appropriate for water pressure up to 55 psi.

Note: If Valve parts are needed, you can purchase the parts listed either the complete valve w/ stem & float (#118) or valve itself (#122).

Updated November 2015

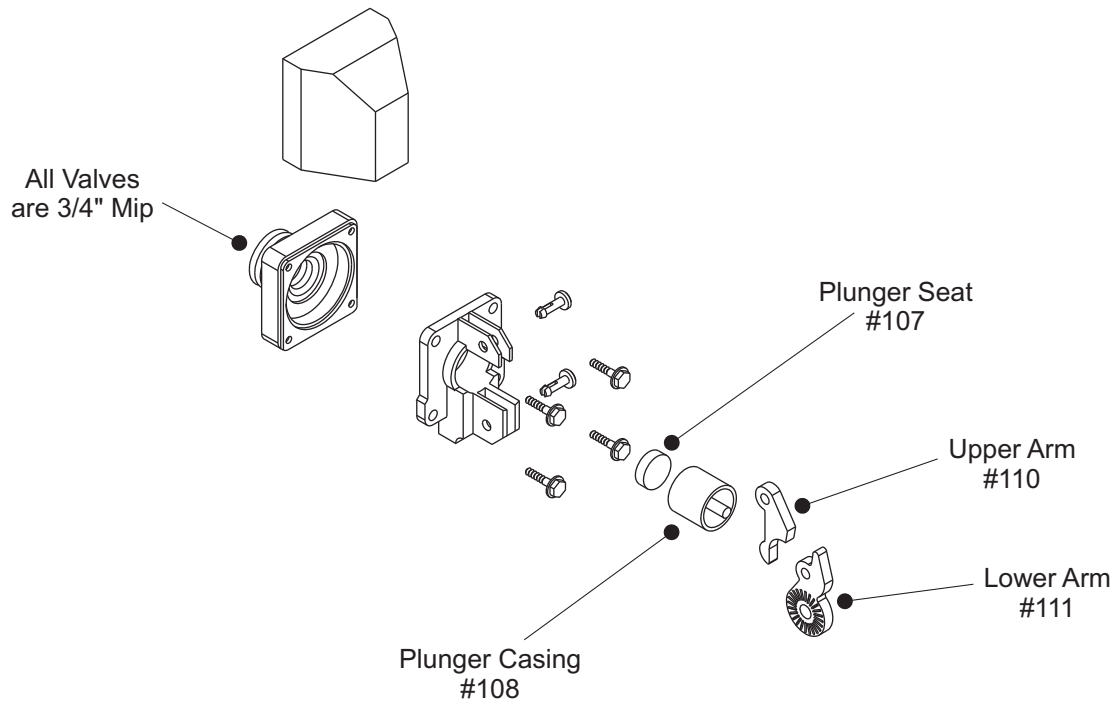

* Approximate water flow rate of the Float and Valve System with a standard 40-60 psi is 5 - 7 gallons per minute.

Water Pressure: Please note the valve is appropriate for water pressure up to 55 psi.

Note: If Valve parts are needed, you can purchase the parts listed either the complete valve w/ stem & float (#118) or valve itself (#122).

Copyright © 2001 - 2017
SPI Industries Inc. All rights reserved
Printed in Canada.